

**SAMSUNG**

BD-J4500R

# Blu-ray™ Disc Player

## user manual

imagine the possibilities

Thank you for purchasing this Samsung product.  
To receive more complete service,  
please register your product at  
[www.samsung.com/register](http://www.samsung.com/register)

ENGLISH

# Safety Information

## Warning

### CAUTION

#### RISK OF ELECTRIC SHOCK DO NOT OPEN

**CAUTION** : TO REDUCE THE RISK OF ELECTRIC SHOCK, DO NOT REMOVE THE COVER (OR BACK). THERE ARE NO USER SERVICEABLE PARTS INSIDE. REFER ALL SERVICING TO QUALIFIED PERSONNEL.



This symbol indicates that high voltage is present inside. It is dangerous to make any kind of contact with any internal part of this product.



This symbol indicates that important literature concerning operation and maintenance has been included with this product.

- The slots and openings in the cabinet and in the back or bottom are provided for necessary ventilation. To ensure reliable operation of this apparatus, and to protect it from overheating, these slots and openings must never be blocked or covered.
  - Do not place this apparatus in a confined space, such as a bookcase, or built-in cabinet, unless proper ventilation is provided.
  - Do not place this apparatus near or over a radiator or heat register, or where it is exposed to direct sunlight.
  - Do not place vessels (vases etc.) containing water on this apparatus. A water spill can cause a fire or electric shock.
- Do not expose this apparatus to rain or place it near water (near a bathtub, washbowl, kitchen sink, or pool, etc.). If this apparatus accidentally gets wet, unplug it and contact an authorized dealer immediately.
- This apparatus uses batteries. In your community, there might be environmental regulations that require you to dispose of these batteries properly. Please contact your local authorities for disposal or recycling information.
- Do not overload wall outlets, extension cords or adaptors beyond their capacity, since this can result in fire or electric shock.
- Route power-supply cords so that they are not likely to be walked on or pinched by items placed on or against them. Pay particular attention to cords at the plug end, at wall outlets, and the point where they exit from the apparatus.
- To protect this apparatus from a lightning storm, or when it is left unattended and unused for long periods of time, unplug it from the wall outlet and disconnect the antenna or cable system. This will prevent damage to the set due to lightning and power line surges.
- Before connecting the AC power cord to the DC adaptor outlet, make sure the voltage designation of the DC adaptor corresponds to the local electrical supply.
- Never insert anything metallic into the open parts of this apparatus. Doing so may create a danger of electric shock.
- To avoid electric shock, never touch the inside of this apparatus. Only a qualified technician should open this apparatus.
- Make sure to plug the power cord in until it is firmly seated. When unplugging the power cord from a wall outlet, always pull on the power cord's plug. Never unplug by pulling on the power cord. Do not touch the power cord with wet hands.
- If this apparatus does not operate normally - in particular, if there are any unusual sounds or smells coming from it - unplug it immediately and contact an authorized dealer or service centre.
- Maintenance of Cabinet.
  - Before connecting other components to this product, be sure to turn them off.
  - If you move your product suddenly from a cold place to a warm place, condensation may occur on the operating parts and lens and cause abnormal disc playback. If this occurs, unplug the product, wait for two hours, and then connect the plug to the power outlet. Then, insert the disc, and try to play back again.
- Be sure to pull the power plug out of the outlet if the product is to remain unused or if you are leaving the house for an extended period of time (especially when children, elderly, or disabled people will be left alone in the house).
  - Accumulated dust can cause an electric shock, an electric leakage, or a fire by causing the power cord to generate sparks and heat or the insulation to deteriorate.
- Contact an authorized service centre for information if you intend to install your product in a location with heavy dust, high or low temperatures, high humidity, chemical substances, or where it will operate 24 hours a day such as in an airport, a train station, etc. Failing to do so may lead to serious damage of your product.
- Use only a properly grounded plug and wall outlet.
  - An improper ground may cause electric shock or equipment damage. (Class I Equipment only)
- To turn this apparatus off completely, you must disconnect it from the wall outlet. Consequently, the wall outlet and power plug must be readily accessible at all times.
- Do not allow children to hang on the product.
- Store the accessories (battery, etc.) in a location safely out of the reach of children.
- Do not install the product in an unstable location such as a shaky self, a slanted floor, or a location exposed to vibration.
- Do not drop or strike the product. If the product is damaged, disconnect the power cord and contact a service centre.
- To clean this apparatus, unplug the power cord from the wall outlet and wipe the product using a soft, dry cloth. Do not use any chemicals such as wax, benzene, alcohol, thinners, insecticide, air fresheners, lubricants, or detergent. These chemicals can damage the appearance of the product or erase the printing on the product.
- Do not expose this apparatus to dripping or splashing. Do not put objects filled with liquids, such as vases on the apparatus.
- Do not dispose of batteries in a fire.
- Do not plug multiple electric devices into the same wall socket. Overloading a socket can cause it to overheat, resulting in a fire.
- There is danger of an explosion if you replace the batteries used in the remote with the wrong type of battery. Replace only with the same or equivalent type.

- WARNING - TO PREVENT THE SPREAD OF FIRE, KEEP CANDLES AND OTHER ITEMS WITH OPEN FLAMES AWAY FROM THIS PRODUCT AT ALL TIMES.



## CLASS 1 LASER product

This Compact Disc player is classified as a CLASS 1 LASER product. Use of controls, adjustments or performance of procedures other than those specified herein may result in hazardous radiation exposure.

### CAUTION :

- INVISIBLE LASER RADIATION WHEN OPEN AND INTERLOCKS DEFEATED, AVOID EXPOSURE TO BEAM.

CLASS 1	LASER PRODUCT
KLASSE 1	LASER PRODUKT
LUOKAN 1	LASER LAITE
KLASS 1	LASER APPARAT
PRODUCTO	LASER CLASE 1

## Wiring the Main Power Supply Plug (UK Only)

**IMPORTANT NOTICE :** The mains lead on this equipment is supplied with a moulded plug incorporating a fuse. The value of the fuse is indicated on the pin face of the plug and if it requires replacing, a fuse approved to BS1362 of the same rating must be used. Never use the plug with the fuse cover removed. If the cover is detachable and a replacement is required, it must be of the same colour as the fuse fitted in the plug.

Replacement covers are available from your dealer. If the fitted plug is not suitable for the power points in your house or the cable is not long enough to reach a power point, you should obtain a suitable safety approved extension lead or consult your dealer for assistance. However, if there is no alternative to cutting off the plug, remove the fuse and then safely dispose of the plug. Do not connect the plug to a mains socket as there is a risk of shock hazard from the bared flexible cord. Never attempt to insert bare wires directly into a mains socket. A plug and fuse must be used at all times.

**IMPORTANT :** The wires in the mains lead are coloured in accordance with the following code:– BLUE = NEUTRAL BROWN = LIVE As these colours may not correspond to the coloured markings identifying the terminals in your plug, proceed as follows:–The wire coloured BLUE must be connected to the terminal marked with the letter N or coloured BLUE or BLACK. The wire coloured BROWN must be connected to the terminal marked with the letter L or coloured BROWN or RED.

**IMPORTANT : DO NOT CONNECT EITHER WIRE TO THE EARTH TERMINAL WHICH IS MARKED WITH LETTER E OR BY THE EARTH SYMBOL  $\perp$ , OR COLOURED GREEN OR GREEN AND YELLOW.**

# Contents

## SAFETY INFORMATION

Warning..... 2

## GETTING STARTED

Before using the User Manual..... 4

Logos of Discs the player can play ..... 4

Accessories..... 6

Front Panel..... 7

Rear Panel..... 7

Remote Control ..... 7

## CONNECTIONS

Connecting to a TV..... 8

Connecting to an Audio System ..... 8

## SETTINGS

The Setup Procedure..... 9

Menu Navigation..... 9

Accessing the Settings Menu ..... 9

Picture Settings ..... 9

Sound Settings..... 10

System Settings ..... 11

Language Settings..... 12

Security Settings..... 12

Support Settings ..... 13

## MEDIA PLAY

Playing a Commercially Recorded Disc..... 13

Playing Files on a USB Device ..... 13

Playing a Disc with User Recorded Content .. 14

Controlling Video Playback ..... 14

Controlling Music Playback..... 15

Playing Photo Contents ..... 16

## APPENDIX

Troubleshooting..... 17

Specifications ..... 18

# Getting Started

## Before using the User Manual

### Disc Types and Contents your player can play

Media	Disc Type	Details
VIDEO	Blu-ray Disc	BD-ROM or BD-RE/-R recorded in the BD-RE format.
	DVD-VIDEO DVD-RW DVD-R DVD+RW DVD+R	DVD-VIDEO, recorded DVD+RW/DVD-RW(V)/DVD-R/+R that have been recorded and finalised, or a USB storage media containing DivX, MKV or MP4 contents.
MUSIC	CD-RW/-R, DVD-RW/-R, BD-RE/-R	Music recorded on CD-RW/-R, DVD-RW/-R, BD-RE/-R or a USB storage media containing MP3 or WMA contents.
PHOTO	CD-RW/-R, DVD-RW/-R, BD-RE/-R	Photos recorded on CD-RW/-R, DVD-RW/-R, BD-RE/-R or a USB storage media containing JPEG contents.

#### NOTES

- The player may not play certain CD-RW/-R and DVD-R because of the disc type or recording conditions.
- If a DVD-RW/-R has not been recorded properly in DVD video format, it will not be playable.
- Your player will not play content that has been recorded on a DVD-R at a bit-rate that exceeds 10 Mbps.
- Your player will not play content that has been recorded on a BD-R or USB device at a bit rate that exceeds 25 Mbps.
- Playback may not work for some types of discs, or when you use specific functions, such as angle change and aspect ratio adjustment. Information about the discs is written in detail on the disc box. Please refer to this if necessary.
- When you play a BD-J title, loading may take longer than a normal title or some functions may perform slowly.









### Disc types your player cannot play

- HD DVD
- DVD-RAM
- DVD-RW (VR mode)
- 3.9 GB DVD-R for Authoring.
- DVD-ROM/PD/MV, etc
- Super Audio CD (except CD layer)
- CVD/CD-ROM/CDV/CD-G/CD-I/LD (CD-Gs play audio only, not graphics.)

### Region Code

Both players and discs are coded by region. These regional codes must match for a disc to play. If the codes do not match, the disc will not play.

The Region Code for this player is displayed on the rear panel of the player.

Disc Type	Region Code	Area
Blu-ray Disc		North America, Central America, South America, Korea, Japan, Taiwan, Hong Kong and South East Asia.
		Europe, Greenland, French territories, Middle East, Africa, Australia and New Zealand.
		India, China, Russia, Central and South Asia.
DVD-VIDEO		The U.S., U.S. territories and Canada
		Europe, Japan, the Middle East, Egypt, Africa, Greenland
		Taiwan, Korea, the Philippines, Indonesia, Hong Kong
		Mexico, South America, Central America, Australia, New Zealand, Pacific Islands, Caribbean
		Russia, Eastern Europe, India, North Korea, Mongolia
		China

### Logos of Discs the player can play

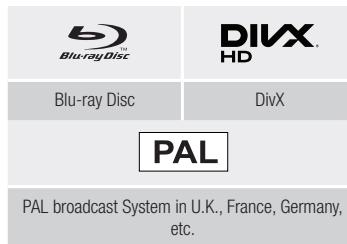

### Supported File Formats

#### Notes on the USB connection

- Your player supports USB storage media, MP3 players, digital cameras, and USB card readers.
- The player does not support folder or file names longer than 128 characters.
- Some USB/External HDD/digital camera devices may not be compatible with the player.
- Your player supports the FAT16, FAT32, and NTFS file systems.
- Connect USB devices directly to the player's USB port. Connecting through a USB cable may cause compatibility problems.
- Inserting more than one memory device into a multi-card reader may cause the reader to operate improperly.
- The player does not support the PTP protocol.

- Do not disconnect a USB device during a "loading" process.
- The bigger the image resolution, the longer the image takes to display.
- This player cannot play MP3 files with DRM (Digital Rights Management) downloaded from commercial sites.
- Your player only supports video with a frame rate under 30fps (frames per second).
- Your player only supports USB Mass Storage Class (MSC) devices such as thumb drives and USB HDD. (HUB is not supported.)
- Certain USB HDD Devices, multi-card readers and thumb drives may not be compatible with this player.
- If some USB devices require excessive power, they may be limited by the circuit safety device.
- If playback from a USB HDD is unstable, provide additional power by plugging the HDD into a wall socket.  
If the problem continues, contact the USB HDD manufacturer.
- SAMSUNG is not responsible for any data file damage or data loss.
- Your player does not support NTFS compressed files, sparse files, or encrypted files.
- You can repair or format a USB device on your Desktop PC. (MS-Windows OS only).

## Video File Support

File Extension	Container	Video Codec	Audio Codec	Resolution
*.avi	AVI	DivX 3.11/4/5/6	MP3 Dolby Digital DTS WMA PCM	1920x1080
		MP4v3		1920x1080
		H.264 BP/MP/HP		1920x1080
*.mkv	MKV	VC-1 AP	MP3 Dolby Digital DTS	1920x1080
		H.264 BP/MP/HP		1920x1080
*.wmv	WMV (wmv9)	VC-1 AP	WMA	1920x1080
		VC-1 SM		1920x1080
*.mp4	MP4	MP4 (mp4v)	AAC	1920x1080
		H.264 BP/MP/HP		1920x1080
*.mpg *.mpeg	MPEG	MPEG1	MP1, 2 Dolby Digital DTS	1920x1080
		MPEG2		1920x1080
		H.264 BP/MP/HP		1920x1080

### • Limitations

- Even when a file is encoded by a supported codec listed above, the file might not be played if its content has a problem.
- Normal playback is not guaranteed if the file's container information is wrong or the file itself is corrupted.
- Files having a higher Bit rate/frame rate than standard may stutter during sound/video playback.
- The Seek (skip) function is not available if the file's index table is damaged.

### • Video decoder

- Supports up to H.264 Level 4.1 and AVCHD
- Does not support H.264 FMO/ASO/RS and VC-1 SP/MP/AP L4
- MPEG4 SP, ASP :  
Below 1280 x 720 : 60 frames max  
Above 1280 x 720 : 30 frames max
- Does not support GMC 2 or higher

#### • Audio decoder

- Supports WMA 7, 8, 9 and STD
- Does not support WMA sampling rate of 22050Hz mono.
- AAC: Max sampling rate: 96Khz (8, 11, 12, 16, 22,24, 32,44.1, 48, 64, 88.2, 96)  
Max bit rate: 320kbps

#### ■ Supported DivX subtitle file formats

\*.txt, \*.smi, \*.srt, \*.sub, \*.txt

#### 📎 NOTES

- Playback of some DivX, MKV or MP4 file may not be supported depending on their video resolution and frame rate.

#### Music File Support

File Extension	Container	Audio Codec	Support Range
*.mp3	MP3	MP3	-
*.wma	WMA	WMA	* Sampling rates (in kHz) - 8, 11, 16, 22, 32, 44.1, 48 * Bit rates - All bit-rates from 5kbps to 355kbps

#### Picture File Support

File Extension	Type	Resolution
*.jpg *.jpeg *.jpe	JPEG	15360x8640
*.png	PNG	15360x8640

#### AVCHD (Advanced Video Codec High Definition)

- This player can play back AVCHD format discs. These discs are normally recorded and used in camcorders.
- The AVCHD format is a high definition digital video camera format.
- The MPEG-4 AVC/H.264 format compresses images with greater efficiency than the conventional image compressing format.

- Some AVCHD discs use the "x.v.Colour" format. This player can play back AVCHD discs that use "x.v.Colour" format.
- "x.v.Colour" is a trademark of Sony Corporation.
- "AVCHD" and the AVCHD logo are trademarks of Matsushita Electronic Industrial Co., Ltd. and Sony Corporation.

#### 📎 NOTES

- Some AVCHD format discs may not play, depending on the recording condition. AVCHD format discs need to be finalised.
- "x.v.Colour" offers a wider colour range than normal DVD camcorder discs.

- Figures and illustrations in this User Manual are provided for reference only and may differ from actual product appearance.
- An administration fee may be charged if either
  - a. an engineer is called out at your request and there is no defect in the product (i.e. where you have failed to read this user manual)
  - b. you bring the unit to a repair centre and there is no defect in the product (i.e. where you have failed to read this user manual).
- The amount of such administration charge will be advised to you before any work or home visit is carried out.

#### Accessories

Check for the supplied accessories shown below.



Batteries for Remote Control  
(AAA Size)

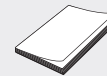

User Manual



Remote Control

## Front Panel

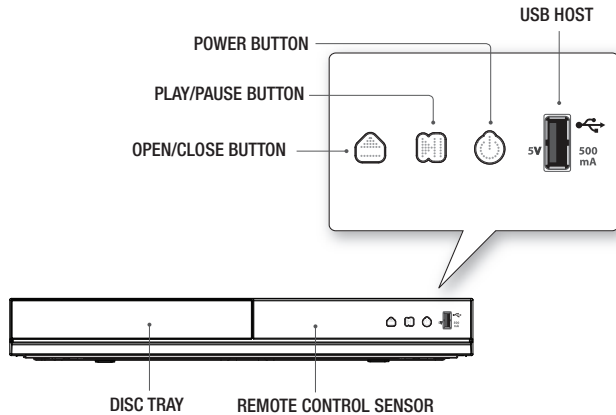

### NOTES

- When the player displays the Blu-ray Disc menu, you cannot start the movie by pressing the Play button on the player or the remote. To play the movie, you must select Play Movie or Start in the disc menu, and then press the button.
- You can perform software upgrades using the USB Host jack with a USB flash memory stick only.

## Rear Panel

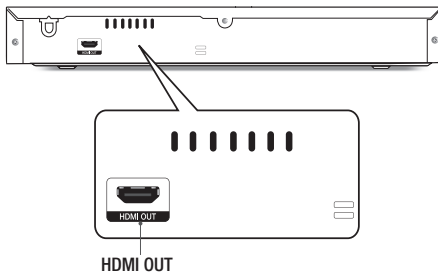

## Remote Control

### Tour of the Remote Control

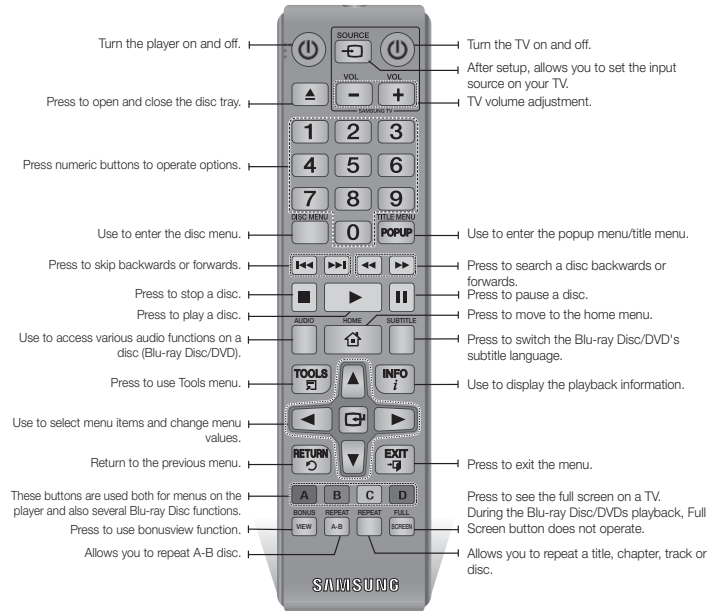

### Installing batteries

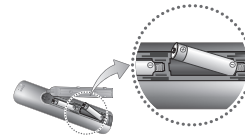

### NOTES

- If the remote does not operate properly:
  - Check the polarity (+/-) of the batteries.
  - Check if the batteries are drained.

- Check if the remote sensor is blocked by obstacles.
- Check if there is any fluorescent lighting nearby.

### ! CAUTION

- Dispose of batteries according to local environmental regulations. Do not put them in the household trash.
- Do not dispose of batteries in a fire.
- Do not short circuit, disassemble or overheat the batteries.
- Danger of explosion if battery is incorrectly replaced. Replace only with the same or equivalent type.

# Connections

## Connecting to a TV

Connect an HDMI cable (not supplied) from the HDMI OUT jack on the back of the product to the HDMI IN jack on your TV.

- Do not connect the power cord to the wall outlet until you have made all the other connections.
- When you change the connections, turn off all devices before you start.

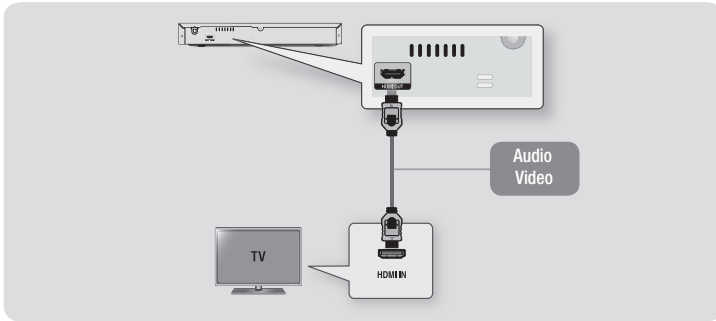

### NOTES

- Depending on your TV, certain HDMI output resolutions may not work. Please refer to the user manual of your TV.
- When you connect the player to your TV using the HDMI cable or to a new TV, and then turn it on for the first time, the player automatically sets the HDMI output resolution to the highest supported by the TV.
- A long HDMI cable may cause screen noise. If this occurs, set HDMI Deep Colour to Off in the menu.
- To view video in the HDMI 720p, 1080i, or 1080p output mode, you must use a High speed HDMI cable.
- HDMI outputs only a pure digital signal to the TV.  
If your TV does not support HDCP (High-bandwidth Digital Content Protection), random noise appears on the screen.

## Connecting to an Audio System

You can connect the Blu-ray player to an audio system using illustrated below.

- Do not connect the power cord to the wall outlet until you have made all the other connections.
- When you change the connections, turn off all devices before you start.

## Connecting to an HDMI supported AV receiver

- Connect an HDMI cable (not supplied) from the HDMI OUT jack on the back of the product to the HDMI IN jack on your receiver.
- Best quality (Recommended)

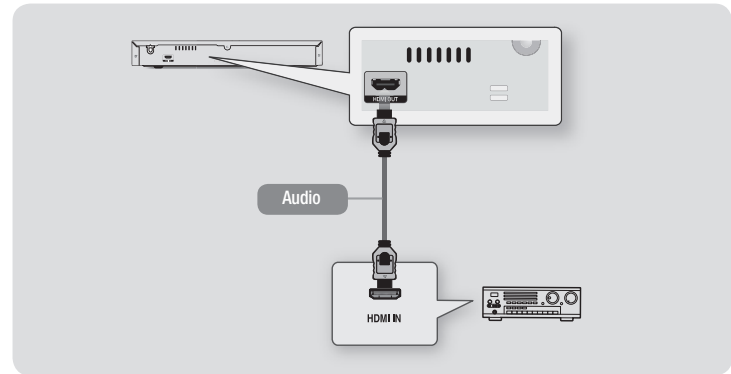



# Settings

## The Setup Procedure

- The Home screen will not appear if you do not configure the setup.
- The OSD (On Screen Display) may change in this player after you upgrade the software version.
- The access steps may differ depending on the menu you selected.
- After the setup process is complete, you can then operate the panel buttons and remote control.

After you have connected the player to your TV, turn on the TV and player. When you turn on the player the first time, the player's Setup screen appears on the TV. The setup procedure lets you set the On Screen menu languages, the aspect ratio (screen size).

### NOTES

- If you want to display the Setup screen again to make changes, press the **▶||** button on the front panel of the player for more than 5 seconds with no disc inserted. This resets the player to its default settings.
- After the setup process is complete, you can operate the HDMI-CEC function.
- If you want to use the Anynet+(HDMI-CEC) function to aid in the initial set up process, please follow the instructions below.
  - 1) Connect the player to an Anynet+(HDMI-CEC) compliant Samsung TV using HDMI Cable.

- 2) Set the Anynet+(HDMI-CEC) feature to On in both the TV and the player.
  - 3) Set the TV to the Setup Procedure.
- If you leave the player in the stop mode for more than 5 minutes without using it, a screen saver will appear on your TV. If the player is left in the screen saver mode for more than 25 minutes, the power will automatically turn off.

## Menu Navigation

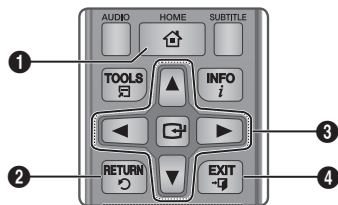

1	<b>HOME</b> Button : Press to move to the Home menu.
2	<b>RETURN</b> Button : Return to the previous menu.
3	<b>Enter</b> / <b>DIRECTION</b> Button : Move the cursor or select an item. Activate the currently selected item. Confirm a setting.
4	<b>EXIT</b> Button : Press to exit the current menu.

## Home Menu

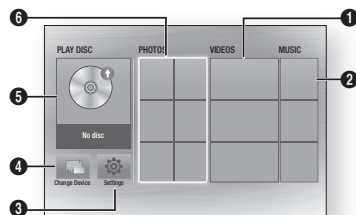

1	Selects VIDEOS.
2	Selects MUSIC.
3	Selects Settings.
4	Selects Change Device.
5	Selects PLAY DISC.
6	Selects PHOTOS.

### NOTES

- The Videos, Photos, and Music options require that you have an appropriate disc inserted into the player or a USB flash device attached to the player.

## Accessing the Settings Menu

To access the Settings menu and sub-menus, follow these steps:

1. Press the **POWER** button. The Home Menu appears.
2. Press the **▲▼◀▶** buttons to select **Settings**, and then press the **Enter** button.

3. Press the **▲▼** buttons to select the desired submenu, and then press the **Enter** button.
4. Press the **▲▼** buttons to select the desired item, and then press the **Enter** button.
5. Press the **EXIT** button to exit the menu.

### NOTES

- The access steps may differ depending on the menu you selected. The OSD (On Screen Display) may change in this player after you upgrade the software version.

## Picture Settings

You can configure various display options such as the TV Aspect Ratio, Resolution, etc.

## TV Aspect Ratio

Depending on the type of television you have, you may want to adjust the screen size setting.

### NOTES

- Depending on the disc type, some aspect ratios may not be available.
- If you select an aspect ratio and option which is different than the aspect ratio of your TV screen, the picture might appear to be distorted.

## BD Wise (Samsung TVs only)

BD Wise is Samsung's latest inter-connectivity feature.

When you connect a Samsung player and a Samsung TV with BD Wise to each other via HDMI, and BD Wise is on in both the player and TV, the player outputs video at the video resolution and frame rate of the Blu-ray Disc/DVDs.

### NOTES

- When BD Wise is on, the Resolution setting automatically defaults to BD Wise and BD Wise appears in the Resolution menu.
- If the player is connected to a device that does not support BD Wise, you cannot use the BD Wise function.
- For proper operation of BD Wise, set the BD Wise menu of both the player and the TV to On.

## Resolution

Lets you set the output resolution of the HDMI video signal to Auto, 1080p, 1080i, 720p or 576p/480p. The number indicates the number of lines of video per frame. The i and p indicate interlaced and progressive scan, respectively. The more lines, the higher the quality.

## Resolution according to the output

### mode

- Blu-ray Disc/E-contents/Digital Contents playback

Output Setup	HDMI / connected	
	HDMI Mode	
	Blu-ray Disc	E-contents/ Digital contents
BD Wise	Resolution of Blu-ray Disc	1080p
Auto	Max. Resolution of TV input	Max. Resolution of TV input
1080p@60F (Movie Frame : Off)	1080p@60F	1080p@60F
Movie Frame : Auto (24 fps)	1080p@24F	1080p@24F
1080i	1080i	1080i
720p	720p	720p
576p/480p	576p/480p	576p/480p

- DVD playback

Output Setup	HDMI / connected
	HDMI Mode
BD Wise	576i/480i
Auto	Max. Resolution of TV input
1080p	1080p
1080i	1080i
720p	720p
576p/480p	576p/480p

### NOTES

- If the TV you connected to the player does not support Movie Frame or the resolution you selected, the message "If no pictures are shown after selecting 'Yes', please wait for 15 seconds to return to the previous resolution. Do you want to change the resolution?" appears. If you select **Yes**, the TV's screen will go blank for 15 seconds, and then the resolution will revert to the previous resolution automatically.
- If the screen stays blank after you have changed the resolution, remove all discs, and then press and hold the **▶||** button on the front of the player for more than 5 seconds. All settings are restored to the factory default. Follow the steps on the previous page to access each mode and select the Display Setup that your TV will support.
- When the factory default settings are restored, all stored user BD data is deleted.
- The Blu-ray Disc must have the 24 frame feature for the player to use the Movie Frame (24 fps) mode.

## Movie Frame (24 fps)

Setting the Movie Frame (24 fps) feature to Auto allows you to adjust the player's HDMI output to 24 frames per second for improved picture quality. You can enjoy the Movie Frame (24 fps) feature only on a TV supporting this frame rate. You can select Movie Frame only when the player is in the HDMI 1080p output resolution modes.

## HDMI Colour Format

Lets you set the colour space format for HDMI output to match the capabilities of the connected device (TV, monitor, etc).

## HDMI Deep Colour

Lets you output video from the HDMI OUT jack with Deep Colour. Deep Colour provides more accurate colour reproduction with greater colour depth.

## Progressive Mode

Lets you improve picture quality when viewing DVDs.

## Sound Settings

## Digital Output

Lets you select the digital audio output format that is suitable for your TV or AV Receiver. For more details, please refer to the Digital Output Selection table below.

## Digital Output Selection

Setup		PCM	Bitstream (Unprocessed)	Bitstream (Re-encoded DTS)	Bitstream (Re-encoded Dolby D)
Connection		HDMI Receiver	HDMI Receiver	HDMI Receiver	HDMI supported AV receiver
Audio Stream on Blu-ray Disc	PCM	Up to 7.1ch	PCM	Re-encoded DTS	Re-encoded Dolby Digital *
	Dolby Digital	PCM 2ch	Dolby Digital	Re-encoded DTS	Re-encoded Dolby Digital *
	Dolby Digital Plus	PCM 2ch	Dolby Digital Plus	Re-encoded DTS	Re-encoded Dolby Digital *
	Dolby TrueHD	PCM 2ch	Dolby TrueHD	Re-encoded DTS	Re-encoded Dolby Digital *
	DTS	PCM 2ch	DTS	Re-encoded DTS	Re-encoded Dolby Digital *
	DTS-HD High Resolution Audio	PCM 2ch	DTS-HD High Resolution Audio	Re-encoded DTS	Re-encoded Dolby Digital *
Audio Stream on DVD	PCM	PCM 2ch	PCM 2ch	PCM 2ch	PCM 2ch
	Dolby Digital	PCM 2ch	Dolby Digital	Dolby Digital	Dolby Digital
	DTS	PCM 2ch	DTS	DTS	DTS
Definition for Blu-ray Disc	Any	Decodes main feature audio and BONUSVIEW audio stream together into PCM audio and add Navigation Sound Effects.	Outputs only main feature audio stream so that your AV receiver can decode the audio bitstream. You will not hear BONUSVIEW audio and Navigation Sound Effects.	Decodes main feature audio and BONUSVIEW audio stream together into PCM audio and add Navigation Sound Effects, then re-encodes the PCM audio into DTS bitstream	Decodes main feature audio and BONUSVIEW audio stream together into PCM audio and add Navigation Sound Effects, then re-encodes the PCM audio into Dolby Digital bitstream

\* If Source Stream is 2ch, "Re-encoded Dolby D" Settings are not applied.

Blu-ray Discs may include three audio streams :

- Main Feature Audio : The audio soundtrack of the main feature.
- BONUSVIEW audio : An additional soundtrack such as the director or actor's commentary.
- Navigation Sound Effects : When you choose a menu navigation selection, a Navigation Sound Effect may sound. Navigation Sound Effects are different on each Blu-ray Disc.

## NOTES

- Be sure to select the correct Digital Output or you will hear no sound or just loud noise.
- If the HDMI device (AV receiver, TV) is not compatible with compressed formats (Dolby Digital, DTS), the audio signal outputs as PCM.
- Regular DVDs do not have BONUSVIEW audio and Navigation Sound Effects.
- Some Blu-ray Discs do not have BONUSVIEW audio and Navigation Sound Effects.
- If you play MPEG audio soundtracks, the audio signal outputs as PCM regardless of your Digital Output selections (PCM or Bitstream).
- If your TV is not compatible with compressed multi-channel formats (Dolby Digital, DTS), the player may output PCM 2ch downmixed audio even though you selected Bitstream (either Re-encoded or Unprocessed) in the setup menu.
- If your TV is not compatible with PCM sampling rates over 48kHz, the player may output 48kHz downsampled PCM audio.

## Dynamic Range Control

Lets you apply dynamic range control to Dolby Digital, Dolby Digital Plus, and Dolby TrueHD audio.

- **Auto** : Automatically controls the dynamic range of Dolby TrueHD audio, based on information in the Dolby TrueHD soundtrack. Also turns dynamic range control on for Dolby Digital and Dolby Digital Plus.
- **Off** : Leaves the dynamic range uncompressed, letting you hear the original sound.

- **On** : Turns dynamic range control on for all three Dolby formats. Quieter sounds are made louder and the volume of loud sounds is reduced.

## Downmixing Mode

Lets you select the multi-channel downmix method that is compatible with your stereo system. You can choose to have the player downmix to normal stereo or to surround compatible stereo.

## System Settings

### Setup

By using the Setup function, you can set the language, etc.  
For more information about the Setup function, refer to the setup section of this user manual (See page 9).

### Quick Start

You can turn on the power quickly by decreasing the boot time.

## NOTES

- If this function is set to **On**, Standby power consumption will be increased.

## Anynet+ (HDMI-CEC)

Anynet+ is a convenient function that offers linked operations with other Samsung players that have the Anynet+ feature.

To operate this function, connect this player to an Anynet+ Samsung TV with an HDMI cable.

With Anynet+ on, you can operate this player using a Samsung TV remote control and start disc playback simply by pressing the **PLAY** (  ) button on the TV's remote control.

For more information, please see the TV user manual.

### NOTES

- This function is not available if the HDMI cable does not support CEC.
- If your Samsung TV has an Anynet+ logo, then it supports the Anynet+ function.
- Depending on your TV, certain HDMI output resolutions may not work. Please refer to the user manual of your TV.
- If you have Anynet+ turned on, when you turn off the product, disconnect, and then reconnect the power cable, the product turns on automatically to re-establish the Anynet+ connection. After about 15 seconds, it turns off again automatically.
- Some Samsung TVs, when connected to this product using the Anynet+ function will, when you turn them on, display a warning popup message saying no connection has been found. Never-the-less, the Anynet+ connection is properly established and available to use.

## BD Data Management

Enables you to manage the downloaded contents you accessed through a Blu-ray disc and stored on a flash drive.

You can check the device's information including the storage size, delete the BD data, or change the Flash memory device.

### NOTES

- In the external memory mode, disc playback may be stopped if you disconnect the USB device in the middle of playback.
- Your player supports the FAT16, FAT32, and NTFS file systems. We recommend you use USB devices that support USB 2.0 protocol with 4 MB/sec or faster read/write speed.
- The Resume Play function may not work after you format the storage device.
- The total memory available to BD Data Management may differ, depending on the conditions.

## DivX® Video On Demand

View DivX® VOD Registration Codes to purchase and play DivX® VOD contents.

## Language Settings

You can select the language you prefer for the On-Screen menu, disc menu, audio, and subtitles.

### NOTES

- The selected language will only appear if it is supported on the disc.

## Security Settings

When you access this function for the first time, the PIN screen appears. Enter the default PIN - 0000 - using the number buttons. To change the PIN, use the Change PIN function. Each time you access the Security Settings hereafter, you must enter that four digit PIN. If you don't change the PIN, continue using the default PIN.

## BD Parental Rating

Prevents playback of Blu-ray Discs with specific age ratings unless the 4 digit PIN is entered.

## DVD Parental Rating

This function works in conjunction with DVDs that have been assigned an age rating or numeric rating that indicates the maturity level of the content. These numbers help you control the types of DVDs that your family can watch.

Select the rating level you want to set. For example, if you select Level 6, discs rated above 6 - Level 7 and 8 - will not play. A larger number indicates more mature content.

## Change PIN

Change the 4-digit password used to access security functions.

## If you forget your password

1. Remove any discs.
2. Press and hold the **▶||** button on the front panel for 5 seconds or more. All settings will revert to the factory settings.

### NOTES

- When the factory default settings are restored, all the user stored BD data will be deleted.

## Support Settings

### Software Upgrade

The Software Upgrade menu allows you to upgrade the player's software for performance improvements or additional services.

### By USB

To upgrade by USB, follow these steps:

1. Visit [www.samsung.com/bluraysupport](http://www.samsung.com/bluraysupport).
2. Download the latest USB software upgrade zip archive to your computer.
3. Unzip the zip archive to your computer. You should have a single RUF file with the same name as the zip file.
4. Copy the RUF file to a USB flash drive.
5. Make sure there is no disc in the player, and then insert the USB flash drive into the USB port of the player.
6. In the player's menu, go to **Settings > Support > Software Upgrade**.
7. Select **By USB**.

### NOTES

- No disc should be in the product when you upgrade the software using the USB Host jack.
- When the software upgrade is done, check the software details in the software Upgrade menu.

- Do not turn off the player during the software upgrade. It may cause the player to malfunction.
- Software upgrades using the USB Host jack must be performed with a USB flash memory stick only.

### Contact Samsung

Provides contact information for assistance with your player.

### Reset

Returns all settings to their factory defaults.

## Media Play

### Playing a Commercially Recorded Disc

1. Press the **▶** button to open the disc tray.
2. Place a disc gently into the disc tray with the disc's label facing up.
3. Press the **▶** button to close the disc tray. Playback starts automatically.

### Playing Files on a USB Device

There are two methods you can use to play or view multimedia files located on a USB device through your player.

### Method 1

1. Turn the player on.
2. Connect the USB device to the USB port on the front panel of the player. The New Device Connected pop-up appears.

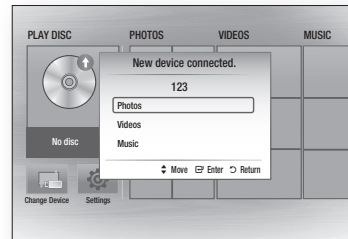

### NOTES

- If the pop-up does not appear, go to Method 2.
3. Use the **▲▼** buttons to select **Photos**, **Videos** or **Music**, and then press the **▶** button. The Photos, Videos & Music screen appears listing the content of the device. Depending on how the contents is arranged, you will see either folders, individual files, or both.

### NOTES

- Even though the player will display folders for all content types, it will only display files of the Content Type you selected in Step 3. For example, if you selected music, you will only be able to see music files. You can change this selection by returning to the Photos, Videos & Music screen and going to Step 3 in Method 2 below.
4. If necessary, use the **▲▼◀▶** buttons to select a folder, and then press the **▶** button.
  5. Select a file to view or play, and then press the **▶** button.
  6. Press the **RETURN** button to exit a folder or the **EXIT** button to return to the Home screen.
  7. Go to pages 14~16 for instructions that explain how to control playback of videos, music, and pictures on a USB device.

## Method 2

1. Turn the player on.
2. Connect the USB device to the USB port on the front panel of the player. Select **Change Device** and then press the **▲▼** button to select **USB**. Press the **☑** button.

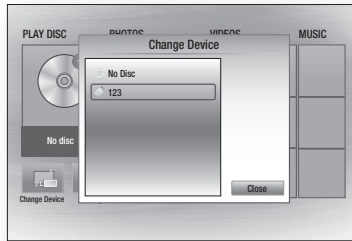

3. Use the **▲▼◀▶** buttons to select **PHOTOS, VIDEOS** or **MUSIC** on the Home screen, and then press the **☑** button. The Photos, Videos & Music screen appears listing the content of the device. Depending on how the contents is arranged, you will see either folders, individual files, or both.

### NOTES

- Even though the player will display folders for all content types, it will only display files of the Content Type you selected in Step 3. For example, if you selected music, you will only be able to see music files. You can change this selection by returning to the Photos, Videos & Music screen and repeating Step 3.
4. If necessary, use the **▲▼◀▶** buttons to select a folder, and then press the **☑** button.

5. Use the **▲▼◀▶** buttons to select a file to view or play, and then press the **☑** button.
6. Press the **RETURN** button to exit a folder or the **EXIT** button to return to Home screen.
7. Go to pages 14~16 for instructions that explain how to control playback of videos, music, and pictures on a USB device.

### NOTES

- If you insert a disc when playing a USB device, the device mode changes to "Disc" automatically.

## Playing a Disc with User Recorded Content

You can play multimedia files you have recorded on Blu-ray, DVD, or CD discs.

1. Place a user recorded disc into the disc tray with the disc's label facing up, and then close the tray.
2. Use the **◀▶** buttons to select the type of content you want to view or play - **Videos, Photos, or Music** - and then press the **☑** button.

### NOTES

- Even though the player will display folders for all content types, it will only display files of the Content Type you selected in Step 2. For example, if you selected music, you will only be able to see music files. You can change this selection by returning to the Home screen and repeating Step 2.

3. A screen appears listing the contents of the disc. Depending on how the contents are arranged, you will see either folders, individual files, or both.
4. If necessary, use the **▲▼◀▶** buttons to select a folder, and then press the **☑** button.
5. Use the **▲▼◀▶** buttons to select a file to view or play, and then press the **☑** button.
6. Press the **RETURN** button one or more times to exit a current screen, exit a folder, or to return to the Home screen. Press the **EXIT** button to return directly to the Home Screen.
7. Go to pages 14~16 for instructions that explain how to control playback of videos, music, and pictures on a disc.

## Controlling Video Playback

You can control the playback of video content located on a Blu-ray disc, DVD, CD, or USB device. Depending on the media, some of the functions described in this manual may not be available.

During Blu-ray or DVD disc playback, the Full screen button does not operate.

## Buttons on the Remote Control used for Video Playback

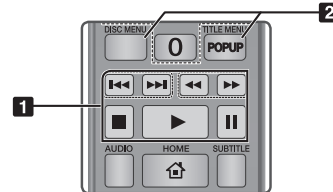

## 1 Playback related buttons

The Player does not play sound in Search, Slow or Step mode.

- To return to normal speed playback, press the **▶** button.

<b>▶</b> button	Starts playback.
<b>⏏</b> button	Stops playback.
<b>⏸</b> button	Pauses playback.
<b>Fast Motion Play</b>	During playback, press the <b>◀◀</b> or <b>▶▶</b> button. Each time you press the <b>◀◀</b> or <b>▶▶</b> button, the playback speed will change.
<b>Slow Motion Play</b>	In pause mode, press the <b>▶▶</b> button. Each time you press the <b>▶▶</b> button, the playback speed will change.
<b>Step Motion Play</b>	In pause mode, press the <b>⏸</b> button. Each time you press the <b>⏸</b> button, a new frame appears.
<b>Skip Motion Play</b>	During playback, press the <b>◀◀</b> or <b>▶▶</b> button. Each time you press the <b>◀◀</b> or <b>▶▶</b> button, the disc moves to the previous or next chapter or file.

## 2 Using the disc menu, title menu, popup menu, and title list

<b>DISC MENU button</b>	During playback, press this button to start the disc menu function.
<b>TITLE MENU button</b>	During playback, press this button to start the title menu function.
<b>POPOP MENU button</b>	During playback, press this button to start the popup menu function.

## Controlling Music Playback

You can control the playback of music located on a Blu-ray disc, DVD, CD, or USB device.

## Buttons on the Remote Control used for Music Playback

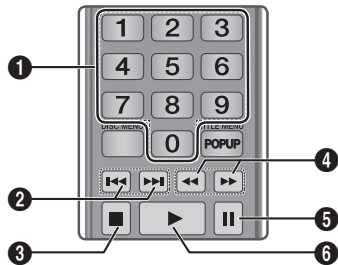

<b>1</b>	<b>NUMBER buttons (Audio CD (CD-DA) only)</b> : During Playlist playback, press the desired track number. The selected track is played.
<b>2</b>	<b>Skip</b> : During playback, press the <b>◀</b> or <b>▶</b> button to move to the previous or next file of the playlist.
<b>3</b>	<b>■</b> button : Stops a track.
<b>4</b>	<b>Fast Play (Audio CD (CD-DA) only)</b> : During playback, press the <b>◀</b> or <b>▶</b> button. Each time you press the <b>◀</b> or <b>▶</b> button, the playback speed will change.
<b>5</b>	<b>Pause</b> : Pauses a track.
<b>6</b>	<b>▶</b> button : Plays the currently selected track.

## Repeat an Audio CD (CD-DA)/MP3

1. During Playlist playback, press the **TOOLS** button.



2. Press the **◀▶** buttons to select **Track**, **All**, **Shuffle**, or **Off**.
3. Press the **■** button.

<b>Off</b>	Songs are played in the order in which they were recorded.
<b>(◀▶) Track</b>	The current song is repeated.
<b>(◀▶) All</b>	All songs are repeated.
<b>(◀▶) Shuffle</b>	Shuffle plays songs in random order.

## Playlist

1. To move to the Music List, press the **■** or **RETURN** button. The Music List screen appears.



2. Press the **▲▼◀▶** buttons to move to a desired track, and then press the **YELLOW (C)** button. A check appears on the track. Repeat this procedure to select additional tracks.
3. To remove a track from the list, move to the track, and then press the **YELLOW (C)** button again. The check on the track is cancelled.

4. When done, press the **■** button. The tracks you selected are displayed on the right side of the screen. The player plays the first track.
5. To change the play list, press the **■** button or **RETURN** button to return to the Music List. Repeat Steps 2, 3, and 4.
6. To cancel the play list and return to the Home screen, press the **RETURN** or **EXIT** button.

## NOTES

- You can create a playlist with up to 99 tracks on Audio CDs (CD-DA).
- If you remove all the tracks from a play list and then press the **■** button, the player lists and plays all the tracks on the disc.

## Ripping

Lets you copy audio files contents from an Audio CD (CD-DA) to USB/HDD device.

1. Open the disc tray. Place the audio (CD-DA) disc on the tray, and close the tray. Insert a USB device into the USB jack on the front of the product.
2. In Stop mode, press the **▲▼◀▶** buttons to move to a desired track, and then press the **YELLOW (C)** button. A check appears on the track. Repeat this procedure to select additional tracks.

- To remove a track from the list, move to the track, and then press the **YELLOW (C)** button again.  
The check on the track is cancelled.
- When done, press the **TOOLS** button and then select the **Rip** using the **▲▼** buttons, and then press the **☑** button. The Rip pop-up appears.
- Use the **▲▼** buttons to select the device to store the ripped files to, and then press the **☑** button.

#### **NOTES**

- Do not disconnect the device while ripping is in progress.
- If you want to cancel ripping, press the **☑** button and then select **Yes**. Select **No** to continue ripping.
  - When ripping is complete, the "Ripping completed." message appears. Press the **☑** button to go back to the Playback screen.

#### **NOTES**

- This function may not be supported by some discs.
- On the Ripping screen, you can also choose **Select All** and **Deselect All**.
  - Use **Select All** to select all tracks. This cancels your individual track selections.
  - Use **Deselect All** to deselect all selected tracks at once.

## Disc Copy to USB

Lets you copy video/photo/music contents from data Disc to USB/HDD device.

- Open the disc tray. Place the data disc on the tray, and close the tray. Insert a USB device into the USB jack on the front of the product. The new device pop-up appears.
- Press the **▲** button, and then press the **◀▶** buttons to select Blu-ray, DVD or CD.
- Use the **▲▼** buttons to select **Photos**, **Videos** or **Music**, and then press the **☑** button. The Photos, Videos & Music screen appears listing the content of the device. Depending on how the contents is arranged, you will see either folders, individual files, or both.

#### **NOTES**

- Even though the player will display folders for all content types, it will only display files of the Content Type you selected in Step 3. For example, if you selected music, you will only be able to see music files. You can change this selection by returning to the Photos, Videos & Music screen and repeating Step 3.
- With the Playback screen displayed, use the **▲▼◀▶** buttons to select the **Videos**, **Photos**, or **Music**, and then press the **YELLOW (C)** button. A check appears to the left of the desired item.

- Repeat Step 4 to select and check additional desired item.
- To remove a desired item from the list, press the **YELLOW (C)** button again. The check on the desired item is removed.
- When done, press the **TOOLS** button and then select the **Copy to USB** using the **▲▼** buttons, and then press the **☑** button. The Copy to USB pop-up appears.
- Use the **▲▼** buttons to select the device to store the copied files, and then press the **☑** button.

#### **NOTES**

- Do not disconnect the device while copying is in progress.
- If you want to cancel copying, press the **☑** button and then select **Yes**. Select **No** to continue copying.
  - When copying is complete, the "Copying completed." message appears. Press the **☑** button to go back to the Playback screen.

#### **NOTES**

- This function may not be supported by some discs.
- On the Copying screen, you can also choose **Select All** and **Deselect All**.
  - Use **Select All** to select all item. This cancels your individual item selections.
  - Use **Deselect All** to deselect all selected item at once.

## Playing Photo Contents

You can control the playback of photo content located on a Blu-ray disc, DVD, CD, or USB device.

### Using the Tools Menu

During playback, press the **TOOLS** button.

<b>Start Slide Show/ Stop Slide Show</b>	Select to start or stop the slide show.
<b>Slide Show Speed</b>	Select to set a slide show's speed.
<b>Background Music</b>	Select to listen to music while viewing a slide show.
<b>Zoom</b>	Select to enlarge the current picture. (Enlarge up to 4 times)
<b>Rotate</b>	Select to rotate the picture. (This will rotate the picture either clockwise or counter clockwise.)
<b>Information</b>	Shows the picture information.

#### **NOTES**

- Depending on the disc or storage device, the Tools menu may differ.
- To enable the background music function, the photo file must be in the same storage media as the music file. However, the sound quality can be affected by the bit rate of the MP3 file, the size of the photo, and the encoding method.
- You can't enlarge the subtitle and PG graphic in the full screen mode.



# Appendix

## Troubleshooting

Before requesting service, please try the following solutions.

PROBLEM	SOLUTION
No operation can be performed with the remote control.	<ul style="list-style-type: none"> <li>• Check the batteries in the remote control. They may need replacing.</li> <li>• Operate the remote control at a distance of no more than 6.1m from the player.</li> <li>• Remove batteries and hold down one or more buttons for several minutes to drain the microprocessor inside the remote control to reset it. Reinstall batteries and try to operate the remote control again.</li> </ul>
Disc does not play.	<ul style="list-style-type: none"> <li>• Ensure that the disc is installed with the label side facing up.</li> <li>• Check the region number of the Blu-ray Disc/DVD.</li> </ul>
Disc Menu does not appear.	<ul style="list-style-type: none"> <li>• Ensure that the disc has disc menus.</li> </ul>
The prohibition message appears on the screen.	<ul style="list-style-type: none"> <li>• This message appears when an invalid button is pressed.</li> <li>• The Blu-ray Disc/DVD's software doesn't support the feature (e.g., angles).</li> <li>• You've requested a title or chapter number or search time that is out of range.</li> </ul>
Play mode differs from the Setup Menu selection.	<ul style="list-style-type: none"> <li>• Some of the functions selected in the Setup Menu may not work properly if the disc is not encoded with the corresponding function.</li> </ul>
The screen ratio cannot be changed.	<ul style="list-style-type: none"> <li>• The Screen Ratio is fixed on your Blu-ray Disc/DVD.</li> <li>• This is not a problem with the player.</li> </ul>
No audio.	<ul style="list-style-type: none"> <li>• Make sure you have selected the correct Digital Output in the Audio Options Menu.</li> </ul>

PROBLEM	SOLUTION
The screen is blank.	<ul style="list-style-type: none"> <li>• If the HDMI output is set to a resolution your TV cannot support (for example, 1080p), you may not see a picture on your TV.</li> <li>• Press the ►► button (on front panel) for more than 5 seconds with no disc inside. All settings will revert to the factory settings.</li> <li>• When the factory default settings are restored, all stored user BD data is deleted.</li> </ul>
Forgot password.	<ul style="list-style-type: none"> <li>• Press the ►► button (on front panel) for more than 5 seconds with no disc inside. All settings including the password will revert to the factory settings.</li> <li>• Don't use this unless absolutely necessary.</li> <li>• When the factory default settings are restored, all stored user BD data is deleted.</li> </ul>
The picture is noisy or distorted.	<ul style="list-style-type: none"> <li>• Make sure that the disc is not dirty or scratched.</li> <li>• Clean the disc.</li> </ul>
No HDMI output.	<ul style="list-style-type: none"> <li>• Check the connection between the TV and the HDMI jack of the player.</li> <li>• Check if your TV supports 576p/480p, 720p, 1080i, or 1080p HDMI input resolutions.</li> </ul>
Abnormal HDMI output screen.	<ul style="list-style-type: none"> <li>• If random noise appears on the screen, it means that TV does not support HDCP (High-bandwidth Digital Content Protection).</li> </ul>
If you experience other problems.	<ul style="list-style-type: none"> <li>• Go to the contents and find the section of the user manual that contains the explanations regarding the current problem, and follow the procedure once again.</li> <li>• If the problem still cannot be solved, please contact your nearest Samsung authorized service centre.</li> </ul>

### NOTES

- When the factory default settings are restored, all stored user BD data is deleted.

## Specifications

General	Weight	1.1 Kg
	Dimensions	300 (W) X 41 (H) X 208 (D) mm
	Operating Temperature Range	+5°C to +35°C
	Operating Humidity Range	10 % to 75 %
USB	Type A	USB 2.0
	DC output	5V 0.5A Max.
HDMI	Video	1080p, 1080i, 720p, 576p/480p
	Audio	PCM, Bitstream

- Design and specifications are subject to change without prior notice.
- For the power supply and power consumption, refer to the label attached to the player.
- Weight and dimensions are approximate.

## Compliance and Compatibility Notice

NOT ALL discs are compatible

- Subject to the restrictions described below and those noted throughout this Manual, including the Disc Type and Characteristics section of this user manual, disc types that can be played are: pre-recorded commercial BD-ROM, DVD-VIDEO, and Audio CD (CD-DA) discs; BD-RE/-R, DVD-RW/-R discs; and CD-RW/-R discs.
- Discs other than those listed above cannot be and are not intended to be played by this player. Some of the discs listed above may not play due to one or more reasons provided below.
- Samsung cannot assure that this player will play every disc bearing the BD-ROM, BD-RE/-R, DVD-VIDEO, DVD-RW/-R, DVD+RW/+R and CD-RW/-R logos, and this player may not respond to all operating commands or operate all features of every disc. These and other disc compatibility and player operation issues with new and existing format discs are possible because:
  - Blu-ray is a new and evolving format and this player may not operate all features of Blu-ray Discs because some features may be optional, additional features may have been added to the Blu-ray Disc format after the production of this player, and certain available features may be subject to delayed availability;
  - not all new and existing disc format versions are supported by this player;
  - new and existing disc formats may be revised, changed, updated, improved and/or supplemented;
  - some discs are produced in a manner that allows specific or limited operation or restricts features during playback;
  - some discs bearing the BD-ROM, BD-RE/-R, DVD-VIDEO, DVD-RW/-R, DVD+RW/+R and CD-RW/-R logos may still be non-standardized discs;
  - some discs may not be played depending on their physical state or recording conditions;
  - problems and errors can occur during the creation of Blu-ray Disc or DVD software and/or the manufacture of discs;
  - this player operates differently than a standard DVD player or other AV equipment; and/or
  - for reasons noted throughout this user manual and for other reason(s) discovered and posted by SAMSUNG customer care centre.
- If you encounter disc compatibility or player operation problems, please contact SAMSUNG customer care centre. You may also contact SAMSUNG customer care centre for possible updates on this player.
- For additional information on playback restrictions and disc compatibility, refer to the Precautions, Before Reading the user manual, Disc Types and Characteristics, and Before Playing sections of this user manual.
- **For Blu-ray Disc Player progressive scan output** : CONSUMERS SHOULD NOTE THAT NOT ALL HIGH DEFINITION TELEVISION SETS ARE FULLY COMPATIBLE WITH THIS product AND MAY CAUSE ARTIFACTS TO BE DISPLAYED IN THE PICTURE. IN CASE OF PROGRESSIVE SCAN PICTURE PROBLEMS, IT IS RECOMMENDED THAT THE USER SWITCH THE CONNECTION TO THE 'STANDARD DEFINITION' OUTPUT. IF THERE ARE QUESTIONS REGARDING OUR TV SET COMPATIBILITY WITH THIS product, PLEASE CONTACT OUR CUSTOMER SERVICE CENTRE.

## Copy Protection

- Because AACS (Advanced Access Content System) is approved as the content protection system for the Blu-ray Disc format, similar to use of CSS (Content Scramble System) for the DVD format, certain restrictions are imposed on playback, analogue signal output, etc., of AACS protected contents.  
The operation of this product and restrictions on this product may vary depending on your time of purchase as those restrictions may be adopted and/or changed by AACS after the production of this product. Furthermore, BD-ROM Mark and BD+ are additionally used as content protection systems for the Blu-ray Disc format, which imposes certain restrictions including playback restrictions for BD-ROM Mark and/or BD+ protected contents. To obtain additional information on AACS, BD-ROM Mark, BD+, or this product, please contact SAMSUNG customer care centre.
- Many Blu-ray Disc/DVDs are encoded with copy protection. Because of this, you should only connect your Player directly to your TV, not to a VCR. Connecting to a VCR results in a distorted picture from copy-protected Blu-ray Disc/DVDs.
- Under the U.S. Copyright laws and Copyright laws of other countries, unauthorized recording, use, display, distribution, or revision of television programs, videotapes, Blu-ray Discs, DVDs, and other materials may subject you to civil and/or criminal liability.
- **Cinavia Notice** : This product uses Cinavia technology to limit the use of unauthorized copies of some commercially-produced film and videos and their soundtracks. When a prohibited use of an unauthorized copy is detected, a message will be displayed and playback or copying will be interrupted. More information about Cinavia technology is provided at the Cinavia Online Consumer Information Centre at <http://www.cinavia.com>. To request additional information about Cinavia by mail, send a postcard with your mailing address to: Cinavia Consumer Information Centre, P.O. Box 86851, San Diego CA, 92138, USA.  
This product incorporates proprietary technology under licence from Verance Corporation and is protected by U.S. Patent 7,369,677 and other U.S. and worldwide patents issued and pending as well as copyright and trade secret protection for certain aspects of such technology. Cinavia is a trademark of Verance Corporation. Copyright 2004-2013 Verance Corporation. All rights reserved by Verance. Reverse engineering or disassembly is prohibited.

## Licence

- Manufactured under licence from Dolby Laboratories. Dolby and the double-D symbol are trademarks of Dolby Laboratories.
- For DTS patents, see <http://patents.dts.com>. Manufactured under licence from DTS Licencing Limited. DTS, the Symbol, & DTS and the Symbol together are registered trademarks, and DTS 2.0+Digital Out is a trademark of DTS, Inc. © DTS, Inc. All Rights Reserved.
- DivX  
This DivX Certified® device has passed rigorous testing to ensure it plays DivX® video.  
To play purchased DivX movies, first register your device at [vod.divx.com](http://vod.divx.com). Find your registration code in the DivX VOD section of your device setup menu. DivX Certified® to play DivX® video up to HD 1080p, including premium content. DivX®, DivX Certified® and associated logos are trademarks of DivX, LLC and are used under licence.  
Covered by one or more of the following U.S. patents: 7,295,673; 7,460,668; 7,515,710; 8,656,183; 8,731,369; RE45,052.
- The terms HDMI and HDMI High-Definition Multimedia Interface, and the HDMI Logo are trademarks or registered trademarks of HDMI Licencing LLC in the United States and other countries.
- Oracle and Java are registered trademarks of Oracle and/or its affiliates. Other names may be trademarks of their respective owners.
- Open Source Licence Notice
  - In the case of using open source software, Open Source Licences are available on the product menu.
- Blu-ray Disc™, Blu-ray™ and the logos are trademarks of the Blu-ray Disc Association.





## UNITED KINGDOM

This Samsung product is warranted for the period of twelve (12) months from the original date of purchase, against defective materials and workmanship. In the event that warranty service is required, you should return the product to the retailer from whom it was purchased.

However, Samsung Authorised Dealers and Authorised Service Centres in other EC Countries will comply with the warranty on the terms issued to purchasers in the country concerned.

In case of difficulty, details of our Authorised Service Centres are available from:

**Samsung Electronics U.K. Ltd. Customer Care**  
Centre PO Box 479 GATESHEAD NE9 9BJ  
United Kingdom

United Kingdom  
Tel : 0330 SAMSUNG (7267864)  
Fax: 03307260001  
[www.samsung.com](http://www.samsung.com)

Eire  
Tel : 0818 717100  
Fax: +44 117 915 6736  
[www.samsung.com](http://www.samsung.com)

### ■ WARRANTY CONDITIONS

1. The warranty is only valid if, when warranty service is required, the warranty card is fully and properly completed and is presented with the original invoice or sales slip or confirmation, and the serial number on the product has not been defaced.
2. Samsung's obligations are limited to the repair or, at its discretion, replacement of the product or the defective part.
3. Warranty repairs must be carried out by Authorised Samsung Dealers or Authorised Service Centres.  
No re-imbusement will be made for repairs carried out by non Samsung Dealers and, any such repair work and damage to the products caused by such repair work will not be covered by this warranty.



## EIRE

4. This product is not considered to be defective in materials nor workmanship by reason that it requires adaptation in order to conform to national or local technical or safety standards in force in any Country other than the one for which the product was originally designed and manufactured. This warranty will not cover, and no re-imbusement will be made for such adaptation nor any damage which may result.
5. This warranty covers none of the following:
  - a) Periodic check ups, maintenance and repair or replacement of parts due to normal wear and tear.
  - b) Cost relating to transport, removal or installation of the product.
  - c) Misuse, including the failure to use this product for its normal purposes or incorrect installation.
  - d) Damage caused by Lightning, Water, Fire, Acts of God, War, Public Disturbances, incorrect mains voltage, improper ventilation or any other cause beyond the control of Samsung.
6. This warranty is valid for any person who legally acquired possession of the product during the warranty period.
7. The consumers statutory rights in any applicable national legislation whether against the retailer arising from the purchase contract or otherwise are not affected by this warranty. Unless there is national legislation to the contrary, the rights under this warranty are the consumers sole rights and Samsung, its subsidiaries and distributors shall not be liable for indirect or consequential loss or any damage to records, compact discs, videos or audio taper or any other related equipment or material.

**SAMSUNG ELECTRONICS (U.K.) LTD.**



## Contact SAMSUNG WORLD WIDE

If you have any questions or comments relating to Samsung products, please contact the SAMSUNG customer care centre.

Area	Contact Centre ☎	Web Site
AUSTRIA	0800 - SAMSUNG (0800 - 7267864)	<a href="http://www.samsung.com/at/support">www.samsung.com/at/support</a>
BELGIUM	02-201-24-18	<a href="http://www.samsung.com/be/support">www.samsung.com/be/support</a> (Dutch) <a href="http://www.samsung.com/be_fr/support">www.samsung.com/be_fr/support</a> (French)
BOSNIA	051 331 999	<a href="http://www.samsung.com/support">www.samsung.com/support</a>
BULGARIA	07001 33 11 , sharing cost	<a href="http://www.samsung.com/bg/support">www.samsung.com/bg/support</a>
CROATIA	062 726 786	<a href="http://www.samsung.com/hr/support">www.samsung.com/hr/support</a>
CZECH	800 - SAMSUNG (800-726786)	<a href="http://www.samsung.com/cz/support">www.samsung.com/cz/support</a>
DENMARK	70 70 19 70	<a href="http://www.samsung.com/dk/support">www.samsung.com/dk/support</a>
FINLAND	030-6227 515	<a href="http://www.samsung.com/fi/support">www.samsung.com/fi/support</a>
FRANCE	01 48 63 00 00	<a href="http://www.samsung.com/fr/support">www.samsung.com/fr/support</a>
GERMANY	0180 6 SAMSUNG bzw. 0180 6 7267864 *10,20 €/Anruf aus dem dt. Festnetz, aus dem Mobilfunk max. 0,60 €/Anruf)	<a href="http://www.samsung.com/de/support">www.samsung.com/de/support</a>
CYPRUS	8009 4000 only from landline, toll free	<a href="http://www.samsung.com/gr/support">www.samsung.com/gr/support</a>
GREECE	80111-SAMSUNG (80111 726 7864) only from land line (+30 210 0897691) from mobile and land line	
HUNGARY	0680SAMSUNG (0680-726-786) 0680PREMIUM (0680-773-648)	<a href="http://www.samsung.com/hu/support">http://www.samsung.com/hu/support</a>
ITALIA	800-SAMSUNG (800.7267864)	<a href="http://www.samsung.com/it/support">www.samsung.com/it/support</a>
LUXEMBURG	261 03 710	<a href="http://www.samsung.com/lu/support">www.samsung.com/lu/support</a>
MONTENEGRO	020 405 888	<a href="http://www.samsung.com/support">www.samsung.com/support</a>
SLOVENIA	080 697 267 090 726 786	<a href="http://www.samsung.com/si/support">www.samsung.com/si/support</a>
NETHERLANDS	0900-SAMSUNG (0900-7267864) (€ 0,10/Min)	<a href="http://www.samsung.com/nl/support">www.samsung.com/nl/support</a>
NORWAY	815 56480	<a href="http://www.samsung.com/no/support">www.samsung.com/no/support</a>
POLAND	0 801-172-678* lub +48 22 607-93-33 ** *(calkowity koszt polaczenia jak za 1 impuls wedlug taryfy operatora) **(koszt polaczenia wedlug taryfy operatora)	<a href="http://www.samsung.com/pl/support">www.samsung.com/pl/support</a>
PORTUGAL	808 20 7267	<a href="http://www.samsung.com/pt/support">www.samsung.com/pt/support</a>
ROMANIA	08008 SAMSUNG (08008 726 7864) TOLL FREE No.	<a href="http://www.samsung.com/ro/support">www.samsung.com/ro/support</a>
SERBIA	011 321 6899	<a href="http://www.samsung.com/rs/support">www.samsung.com/rs/support</a>
SLOVAKIA	0800 - SAMSUNG(0800-726 786)	<a href="http://www.samsung.com/sk/support">www.samsung.com/sk/support</a>
SPAIN	0034902172678	<a href="http://www.samsung.com/es/support">www.samsung.com/es/support</a>
SWEDEN	0771 726 7864 (SAMSUNG)	<a href="http://www.samsung.com/se/support">www.samsung.com/se/support</a>
SWITZERLAND	0848 726 78 64 (0848-SAMSUNG)	<a href="http://www.samsung.com/ch/support">www.samsung.com/ch/support</a> (German) <a href="http://www.samsung.com/ch_fr/support">www.samsung.com/ch_fr/support</a> (French)
U.K	0330 SAMSUNG (7267864)	<a href="http://www.samsung.com/uk/support">www.samsung.com/uk/support</a>
EIRE	0818 717100	<a href="http://www.samsung.com/ie/support">www.samsung.com/ie/support</a>
LITHUANIA	8-800-77777	<a href="http://www.samsung.com/lt/support">www.samsung.com/lt/support</a>
LATVIA	8000-7267	<a href="http://www.samsung.com/lv/support">www.samsung.com/lv/support</a>
ESTONIA	800-7267	<a href="http://www.samsung.com/ee/support">www.samsung.com/ee/support</a>



## Correct disposal of batteries in this product

(Applicable in the European Union and other European countries with separate battery return systems.)

This marking on the battery, manual or packaging indicates that the batteries in this product should not be disposed of with other household waste at the end of their working life. Where marked, the chemical symbols Hg, Cd or Pb indicate that the battery contains mercury, cadmium or lead above the reference levels in EC Directive 2006/66.

If batteries are not properly disposed of, these substances can cause harm to human health or the environment.

To protect natural resources and to promote material reuse, please separate batteries from other types of waste and recycle them through your local, free battery return system.



## Correct Disposal of This Product (Waste Electrical & Electronic Equipment)

(Applicable in the European Union and other European countries with separate collection systems)

This marking on the product, accessories or literature indicates that the product and its electronic accessories (e.g. charger, headset, USB cable) should not be disposed of with other household waste at the end of their working life.

To prevent possible harm to the environment or human health from uncontrolled waste disposal, please separate these items from other types of waste and recycle them responsibly to promote the sustainable reuse of material resources.

Household users should contact either the retailer where they purchased this product, or their local government office, for details of where and how they can take these items for environmentally safe recycling.

Business users should contact their supplier and check the terms and conditions of the purchase contract.

This product and its electronic accessories should not be mixed with other commercial wastes for disposal.

