

WorkForce WF-3640DTWF



Featuring fast business-quality printing of up to 19ppm¹, two 250-sheet front loading paper trays and 8.8cm touch-screen, this Wi-Fi and Ethernet business printer is the perfect way to increase your office productivity. You can also cut your printing costs with high yield XXL black ink that delivers a page yield of approximately 2,200 pages².

A4 duplex 4-in-1

This model comes with a 35-sheet automatic document feeder and offers duplex print, scan, copy and fax functions. In addition to the dual 250-sheet front loading paper trays, the rear speciality paper path means you can print on a wide range of paper, envelopes or labels to suit your business needs.

Mobile printing

Epson Connect³ allows you to print important office documents from smartphones and tablets. You can also print from anywhere in the world by emailing files directly to the printer, and store scanned documents in cloud services. In addition, this printer is also Google Cloud Print and Apple AirPrint compatible. For added versatility, Wi-Fi Direct™ allows easy printing from wireless devices without having to connect to a wireless router.

New printhead

PrecisionCore, Epson's most advanced printhead technology, powers the industry-leading output quality and durability that Epson is renowned for, at the high speeds required for office, commercial and industrial printing.

Durable ink

Epson's DURABrite Ultra Ink is ideal for producing laser-like business documents. Documents are water, smudge and highlighter resistant, while its quick-drying properties make it perfect for duplex printing. Available in 27XXL, 27XL and standard sizes, these high-capacity, individual ink cartridges offer great savings, with a 50% lower cost-per-page than competitive lasers⁴.

DATASHEET



KEY FEATURES

- **A4 4-in-1**
Duplex print, scan, copy and fax
- **Fast print speeds**
Business-quality 19ppm printing¹
- **Connectivity**
Wi-Fi, Wi-Fi Direct and Ethernet
- **Dual paper trays**
Two 250-sheet capacity trays
- **Epson Connect**
Freedom to print and scan anywhere

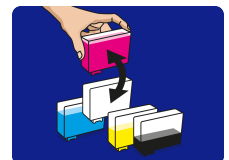

PRODUCT SPECIFICATIONS

TECHNOLOGY

Printing Method	PrecisionCore™ Print Head
Minimum Droplet Size	2.8 pl, With Variable-Sized Droplet Technology
Ink Technology	DURABrite™ Ultra

PRINT

Printing Speed ISO/IEC 24734	19 Pages/min Monochrome, 10 Pages/min Color
Maximum Printing Speed	33 Pages/min Monochrome (plain paper), 20 Pages/min Color (plain paper)
Duplex Printing Speed	9.2 A4 Pages/min Monochrome, 6.3 A4 Pages/min Color
ISO/IEC 24734	
Printing Resolution	4,800 x 2,400 dpi
Max Duty cycle	20,000 Pages per month
Colours	Black, Cyan, Yellow, Magenta

For detailed information on printing speeds please visit <http://www.epson.eu/testing>.

SCAN

Scanning Resolution	1,200 dpi x 2,400 dpi (Horizontal x Vertical)
Output formats	BMP, JPEG, TIFF, PDF, searchable PDF
Scanner type	Contact image sensor (CIS)

FAX

Fax speed dials (max)	100 names and numbers
Page memory	Up to 180 pages (ITU-T No.1 chart)
Fax Functions	Favorites, PC Fax, Auto Redial, Speed Dial

CONNECTIVITY

Interfaces	Hi-Speed USB - compatible with USB 2.0 specification, Ethernet interface (100 Base-TX / 10 Base-T), Wireless LAN IEEE 802.11b/g/n, Wi-Fi Direct
WLAN Security	WEP 64 Bit, WEP 128 Bit, WPA PSK (TKIP), WPA PSK (AES)

OTHER

Warranty	12 months Carry in
----------	--------------------

LOGISTICS INFORMATION

SKU	C11CD16301
Barcode	8715946529608
Dimensions Single Carton	530 x 515 x 393 mm
Carton Weight	14.06 Kg
Multiple Order Quantity	1 Units
Country of Origin	Indonesia
Pallet Size Euro	10 Units (2 x 5)
Pallet Size Block	10 Units (2 x 5)

WorkForce WF-3640DTWF

WHAT'S IN THE BOX

- CD Manual
- Driver and utilities (CD)
- Individual Ink Cartridges
- Main unit
- Power cable
- Quick Start Guide
- Software (CD)
- Warranty document

INK CARTRIDGE COMPATIBILITY



INK YIELD DATA

	Alarm clock 27	Alarm clock 27XL	Alarm clock 27XXL
Black	350 pages*	1,100 pages*	2,200 pages*
Cyan, Magenta, Yellow	300 pages*	1,100 pages*	

* Approx. page yield based on ISO/IEC 24711/24712 or ISO/IEC 29102/29103. Actual yield will vary depending on images printed and usage conditions. For more information visit <http://www.epson.eu/pageyield>



For more information please contact:

Telephone: 0871 222 6702 (UK)+
01 436 7742 (Republic of Ireland)
E-mail: enquiries@epson.co.uk
Fax: 0871 222 6740

Web: www.epson.co.uk
www.epson.ie

+ Calls cost 10p per minute plus network extras.

Trademarks and registered trademarks are the property of Seiko Epson Corporation or their respective owners. Product information is subject to change without prior notice.

1 - Determined in accordance with ISO/IEC 24734 showing the average of ESAT from the Office Category Test for default A4 simplex and duplex. For more information, please visit www.epson.eu/testing 2 - Approx. page yield based on ISO/IEC 24711/24712. Actual yield will vary depending on images printed and usage conditions. For more information visit www.epson.eu/pageyield 3 - Epson iPrint requires a wireless connection and the Epson printing app. Epson Email print, Epson Remote Print Driver and Epson Scan-to-Cloud require a connection to the internet. For more information, supported languages and devices, please visit www.epsonconnect.eu 4 - For more information, please visit www.epson.eu/inkjetsaving

EPSON®